

Automation Manager

A feature available with N-able RMM

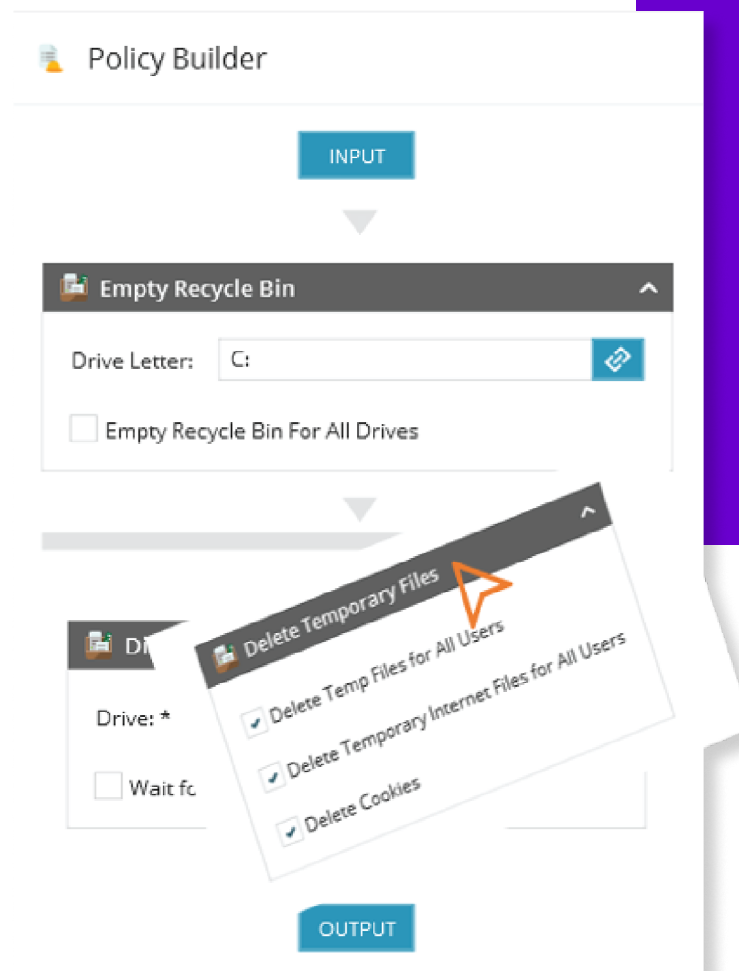

Automation manager is a comprehensive, easy-to-use automation script-building tool. Embedded in the N-able™ RMM platform, it features a drag-and-drop interface for creating custom scripts for checks and automation tasks. From monitoring checks to one-time and repeat tasks, automation manager lets you rest easy, knowing it can handle even the most complex tasks for you.

Time is often an MSP's most valuable resource. Any time you can save automating routine tasks benefits not only you but also your clients. Not all MSPs have the time, resources, or expertise to build all the necessary scripts to automate their processes.

Automation manager in N-able RMM expands on already-powerful management capabilities to allow users to create powerful, multistep, custom scripts. It leverages a vast library of over 600 predefined automation objects, each responsible for performing a specific task—without writing a single line of code.

KEY BENEFITS

- Automate device maintenance processes
- Apply device optimization configurations
- Conduct in-depth device diagnostics
- Automate issue troubleshooting and remediation

Advantages

Maximize technician efficiency through automation

Performing repetitive tasks manually can eat away at your time, which can affect your bottom line. Automation objects can be linked to run in sequence or through conditional settings that launch different execution paths. So, no matter what the task, automation manager in RMM helps save valuable time, so techs can focus on performing higher-value work—and more proactive service for your customers.

No prior scripting knowledge

Automation manager features a drag-and-drop scripting engine, so techs can create powerful automation solutions without being experts in scripting a language. This way, anyone can modify an existing policy template or create a policy from scratch. Just drag objects onto the design canvas and link to other objects to create a multistep policy. No need to rely on your resident scripting guru or spend time combing internet forums for the appropriate scripts

Standardize IT processes

Completing tasks manually is not only time-consuming, but it can also increase the risk of human error. Documenting and automating IT service delivery is your best assurance that tasks are being completed correctly and effectively. Leverage the knowledge of your most valuable technicians by capturing their best practices in automation policies any technician can deploy and execute.

Additionally, take advantage of our automation community for industry best practices. N-able hosts community webinars, boot camps, online forums, and other opportunities to get information and get feedback on scripts. If there are questions that seem ripe for automation, you can create solutions and share them with the community.